

Fog-Free Photo Mirror



Operation Manual



Read instructions before use.
Save for future reference.

INTRODUCTION

The **Fog-Free Photo Mirror** features interchangeable mirrors that slide securely into a lightweight plastic handle. Inside the handle, a battery-powered fan directs a gentle stream of air across the mirror surface to eliminate fogging. Five built-in LEDs help illuminate the mouth for brighter photos and better focusing. Rechargeable, cordless operation provides lasting convenience.

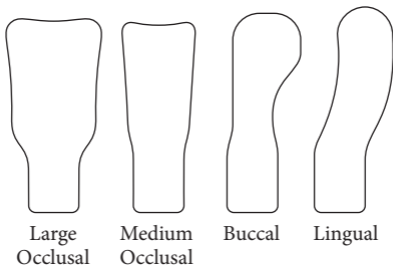



TECHNICAL SPECIFICATIONS

Weight: 79g (2.8 oz.) without mirror
Battery: Lithium-ion 3.7V/1200mAh
Charging Port: USB 2.0 Micro B
Input: 5V 0.5–1A, 50Hz/60Hz
Output: 1.8W Max

CHARGING

1. When the charging LED flashes, LED lights dim, or fan shuts down automatically, stop using the device and recharge the battery.
2. Insert a standard 5V 0.5–1A USB 2.0 Micro B charger (not included) into bottom socket of the device and connect charger to AC power.
3. Solid red LED indicates charging. Solid green LED indicates charging is complete.

INSTRUCTIONS FOR USE

1. Insert the mirror firmly into the bottom slot of the handle until it is fully seated (see Figure 1).
-  2. Press fan button to turn fan ON/OFF.
-  3. Press fan/light button to turn fan and LED lights ON/OFF simultaneously.
4. The device will shut down automatically after three minutes without operation.
5. After use, pull mirror straight out of the handle. Disinfect and clean the mirror and handle according to instructions below.

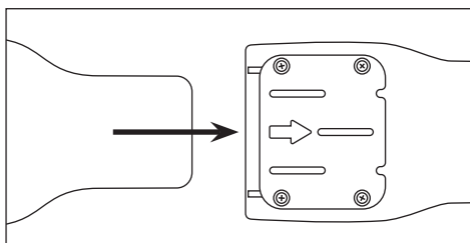

Figure 1. Insert mirror into bottom slot of handle.

DISINFECTION, CLEANING, AND STERILIZATION

1. The handle and the mirror(s) must be cleaned, disinfected, and/or sterilized after each use.
2. Clean and disinfect the handle with a surface disinfectant used per label instructions. Do not autoclave handle. Solutions or wipes containing bleach or alcohol may damage plastic handle.
3. Mirror(s) are steam autoclavable up to 134°C (273°F). Protect polished surfaces of mirror(s) from contact with any other instruments to prevent scratches and preserve reflectivity.

TRANSPORTATION AND STORAGE

Ambient temperature: $-10^{\circ}\text{C}\sim 55^{\circ}\text{C}$ ($-14^{\circ}\text{F}\sim 131^{\circ}\text{F}$)

Relative humidity: $< 85\%$



- Do not drop or shake device.
- Do not expose device to any heat sources.
- Do not place device in contact with liquids.
- Do not put any foreign objects into handle.
- Do not attempt to open or alter device.

BATTERY

If device is stored six (6) months or longer, recharge battery fully before using. Please dispose of handle according to local guidelines or regulations regarding lithium-ion batteries. Do not dispose of device in fire. Do not use device if you suspect it is damaged or defective. If battery is defective, do not transport the device by air under any circumstances.

WARRANTY

Manufacturer warrants its product(s) to original purchaser against manufacturing defects under normal use for a period of one (1) year from date of purchase. Units returned due to manufacturing defects within warranty period will be repaired or replaced at our discretion.

The following are expressly excluded from warranty:

- Damage and/or failure of the device caused by dropping and/or shaking.
- Damage and/or failure of the device caused by natural disasters, incorrect electrical voltage, and voltage spikes.

IMPROPER USE or any attempt to open the device will invalidate the warranty.

Date of purchase _____



IPX0