



# Practicon® Lock-n-Reload™ Automix Cartridge Couplers

## 70-9813 · 20/pack

- Works to combine partially used “leftover” material cartridges.
- Saves time and motion spent switching cartridges mid-procedure.
- Keyed design eliminates the chance of accidental cross-mixing of impression materials during refills.
- Twist-lock prevents cartridge separation during transfer.
- For single-use with rounded flange, 50ml automix cartridges.

---

## Instructions (diagram on other side)

**Important: Before transferring material, be certain that donor and receiver cartridges have the same base/catalyst orientation.**

1. Load donor cartridge into dispensing gun. Squeeze trigger until impression material is visible.
2. Push coupler onto mouth of donor cartridge (Figure 1). Make sure key tab on coupler slides into notch on cartridge. **DO NOT** rotate coupler at this time.
3. Slide receiver cartridge onto coupler and hold in place (Figure 2).
4. Turn coupler firmly in direction of arrow until it locks (Figure 3).
5. Gently squeeze trigger to transfer impression material to receiver cartridge. When finished transferring, disconnect gun and rotate coupler in opposite direction to remove filled receiver cartridge.
6. Dispose of donor cartridge and coupler together.

Manufactured for

---

 **PRACTICON**

PRACTICAL INNOVATIONS FOR DENTISTRY

1-800-959-9505 • Fax 1-800-278-0885

practicon.com • Greenville, NC 27834

Made in China • Inner Pack 709813\_5

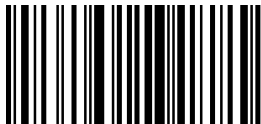

723896016015

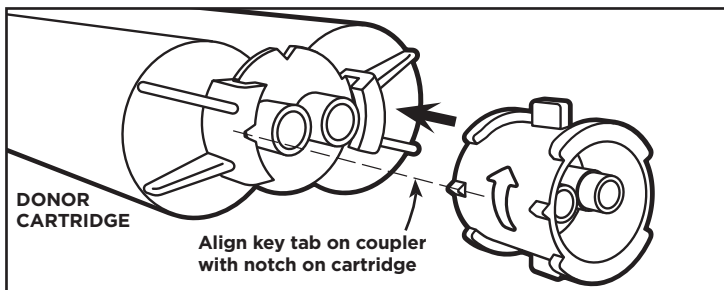

**Figure 1.** Push coupler onto mouth of donor cartridge.

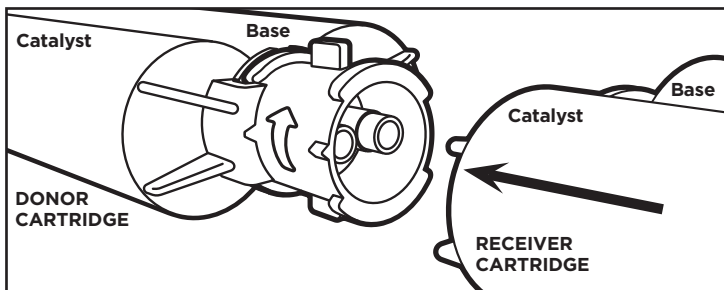

**Figure 2.** Slide receiver cartridge onto coupler and hold in place.

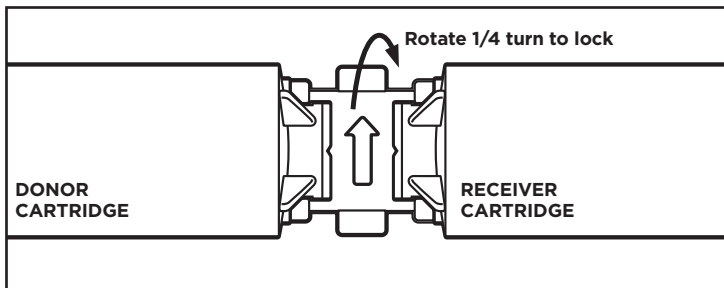

**Figure 3.** Turn coupler firmly in direction of arrow until it locks.