

# Practicon® **Better Faster Cheaper™** **(BFC) Syringes**

## Instructions

Thank you for purchasing **Better Faster Cheaper (BFC) Syringes**. The lightweight, preloadable design of BFC Syringes offers tremendous advantages over the standard automix gun technique. For the ultimate in chairside efficiency, keep a batch of BFC Syringes loaded and ready to use.

Minimize impression material waste by filling BFC syringes with only the amount of wash material you need—half-full is enough to record one crown prep, and full is enough for three preps.



**Figure 1:**  
**Initial Loading Position**

The BFC Syringe comes ready to load. Insert the outlets of the impression material cartridge into the double-barrel and squeeze. Fill the syringe half way for enough to record one crown. Do not fill closer than  $\frac{3}{8}$ " (1 cm) from the top of the double-barrel.

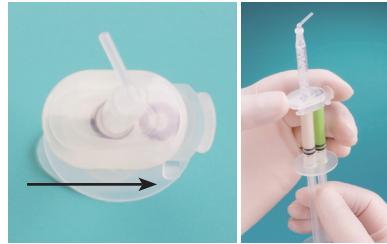

**Figure 2:**  
**Storage Position**

After loading, push the plunger in until the material is almost up to the O-rings. Then, slide the tip portion over until stopped by the side tab. The tab keeps the material from mixing until ready for use.



**Figure 3:**  
**Prepare for Use**

First remove the tab.



**Figure 4:**  
**Slide and Ready**

Slide the tip portion all the way over until it hits the side stop. Always "bleed" some material before going to the mouth.

Manufactured for

 **PRACTICON**  
PRACTICAL INNOVATIONS FOR DENTISTRY

1-800-959-9505 • Fax 1-800-278-0885  
practicon.com • Greenville, NC 27834  
Made in Taiwan • IFU 7090112\_2

US Pat. 7,387,432