

# Practicon® Lock-On™ Saliva Ejector Valve

## Instructions for Use

Thank you for your purchase of the **Lock-On Saliva Ejector Valve**, complete with our exclusive, blue silicone Lock-On Saliva Ejector Valve Tip designed to stay put under tension. It features an ergonomic ON/OFF lever that is easy to use, even under barrier sheaths. Rotate the T-Lever 90° to operate. Lever is reversible for right- or left-handed operation. Fully autoclavable, anodized aluminum construction.

### Package Contents

Item	Description	Qty
A	Lock-On SE Valve Body with Lock-On Tip	2
B	Lock-On SE Quick Disconnect	2
C	Spare Lock-ON SE Valve Tip Viton O-rings	2
D	Instructions for Use	1

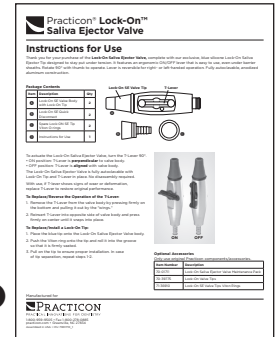
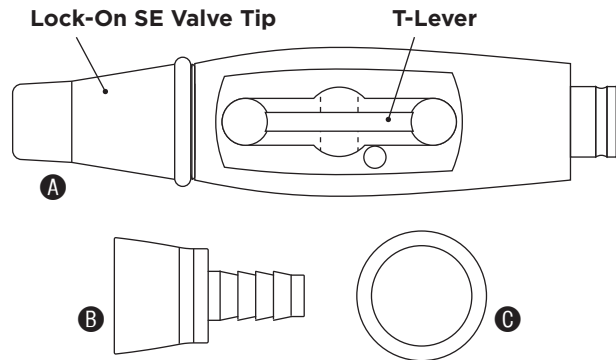

To actuate the Lock-On Saliva Ejector Valve, turn the T-Lever 90°.

- ON position: T-Lever is **perpendicular** to valve body.
- OFF position: T-Lever is **aligned** with valve body.

The Lock-On Saliva Ejector Valve is fully autoclavable with Lock-On Tip and T-Lever in place. No disassembly required.

With use, if T-Lever shows signs of wear or deformation, replace T-Lever to restore original performance.

### To Replace/Reverse the Operation of the T-Lever:

1. Remove the T-Lever from the valve body by pressing firmly on the bottom and pulling it out by the "wings."
2. Reinsert T-Lever into opposite side of valve body and press firmly on center until it snaps into place.

### To Replace/Install a Lock-On Tip:

1. Place the tip onto the Lock-On Saliva Ejector Valve body.
2. Push the Viton ring onto the tip and roll it into the groove so that it is firmly seated.
3. Pull on the tip to ensure proper installation. In case of tip separation, repeat steps 1-2.



### Optional Accessories

Only use original Practicon components/accessories.

Item Number	Description
70-01711	Lock-On SE Valve Maintenance Pack
70-39775	Lock-On SE Valve Tips
71-36910	Lock-On SE Valve Tips Viton Rings

Manufactured for

# PRACTICON

PRACTICAL INNOVATIONS FOR DENTISTRY

1-800-959-9505 • Fax 1-800-278-0885

practicon.com • Greenville, NC 27834

Assembled in USA • IFU 7001710\_1